



Eaton Way, Borehamwood

£299,999

- IDEAL FIRST TIME BUY
- SEPERATE KITCHEN
- Leasehold 118 years remaining
- NO CHAIN
- Good condition
- 2 Bathrooms
- 2 DOUBLE BEDROOMS
- Top floor apartment

Fitzwilliam Court, Eaton Way, WD6

Approximate Area = 55.8 m sq / 601sq ft

For identification only - Not to Scale

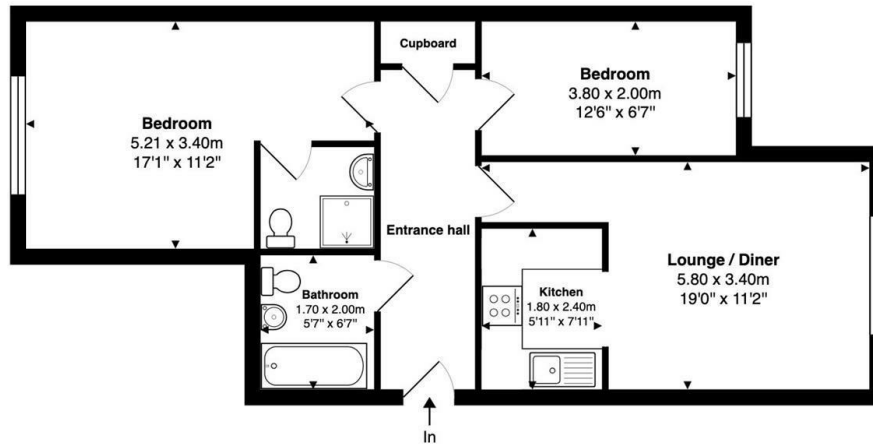

This floor plan is produced in accordance with RICS Property Measurements Standards incorporating International Property Measurement Standards (IPMS2: Residential). The plan is for layout guidance only and not drawn to scale unless otherwise stated. Measurements and position of windows, door openings, rooms and any other items are approximate. Whilst all care is taken in the preparation of this plan, if any aspects of this plan are of specific importance, an independent inspection would be advised

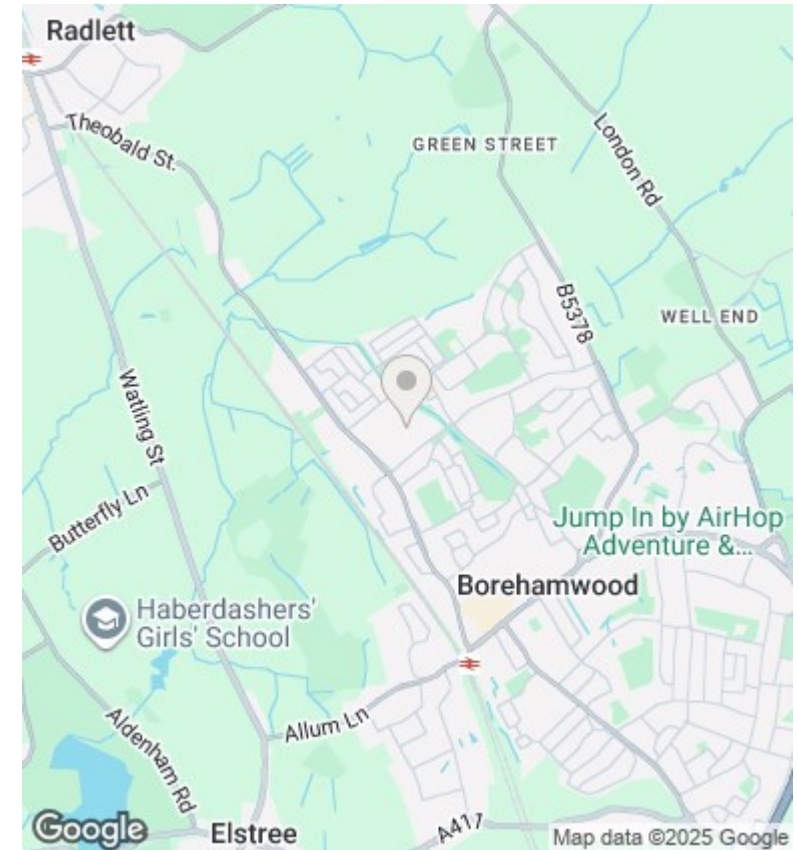

Directions

Fitzwilliam Court development is located just moments from local shops, cafés, and everyday conveniences, the property is also within easy reach of Borehamwood High Street with its wide range of supermarkets, restaurants and leisure facilities. Families will appreciate the excellent choice of nearby schools, including Woodlands Primary, Cowley Hill Primary, Yavneh Primary and Hertswood Academy, all within close proximity. Commuters benefit from superb transport connections: Elstree &

Viewings

Viewings by arrangement only. Call +44 20 3300 3550 to make an appointment.

Council Tax Band

C

EPC Rating:

C

Energy Efficiency Rating		
	Current	Potential
Very energy efficient - lower running costs		
(92-plus) A		
(81-91) B		
(69-80) C	77	
(55-68) D		
(39-54) E		
(21-38) F		
(1-20) G		
Not energy efficient - higher running costs		
England & Wales	EU Directive 2002/91/EC	